

WI-FI SMART LED COLOR CHANGING STRIP KIT

ENER-J®
Smart Home Living

Wi-Fi intelligent controller

Scan two dimensional code to download our application.



iOS APP



Android APP



Download our
FREE APP

ENERJSMART



How to install



Dear users,

Thank you very much for choosing ENER-J's Wi-Fi controller. Our Wi-Fi Smart Color Changing kit adopts the current emerging Wi-Fi technology and top manufacturing process, which is developed integrating years of R&D experience. You can simply download our APP, pair it with your Wi-Fi router and then control this product from your smart phone remotely. For proper installation and usage of the product, please read the below instructions carefully.

Product Features

1. Support Wi-Fi 2.4GHz 802.11 b/g/n wireless network.
2. Support remote/ local control through 2G / 3G /4G / Wi-Fi networks.
3. The main account can share the device with other accounts (subaccounts), (up to max 6 smart phones)

Product Parameters

- Voltage: DC5-12V
- Current: 2A×3CH
- Max Power:72W
- Product size: L290×W25×H9mm
- Working environment: Indoor
- Working temperature: -10°-45°(140°F-113°F)
- Humidity: ≤80% RH

APP Operation

Scan the QR code on the User Manual to download the App. Open the App 'ENERJSMART', click 'Register', and select your country code. If you use phone number, please click next step, and you will receive a verification code. If you use the email option, please click next step and create a password. Set your password with 6 to 20 alphanumeric.

Open APP, click on the upper right "+" and follow the APP prompt to add the device.

NOTE: Before device connection, it is required to reset the device (See FAQs for resetting method)

See specific operation on 《Operation Instruction》

Frequently Asked Questions (FAQ's)

Q: What should I do if I cannot connect the Wi-Fi controller?

- A:
- a. Please check whether device is powered on
 - b. Whether phone is connected to Wi-Fi, and check if your device is connected to the same Wi-Fi which your phone is connected.
 - c. Whether device is ready for configuration.
 - d. Make sure the password entered in App is correct when adding the new device.

Q: How do I reset the device?

A: Power on device. Power off 3 times, until you see the red color flashing.

Instructions

The one-year warranty offered on this product only under certain circumstances. The following situations are not covered by the warranty:

1. Any change, correction, abridged or illegible handwriting on the purchase tags or product instructions
2. Malfunction caused by damage, incorrect connection or misuse.
3. Undesirable phenomena due to the extreme environment rather than the inherent causes of this product (such as lightning, flood, fire etc).
4. This product has been opened or disassembled.
5. Fault caused by any usage, maintenance or custody not according to the product specifications (such as moisture, corrosion).
6. Product fault, appearance deformation, appearance damage or any other physical damage caused by external forces.

Warning

1. Please do not use the device under humid, high temperature environment.
2. Please do not use the product under the water or continuously for more than 10-12hrs.

WI-FI SMART LED COLOR CHANGING STRIP KIT

ENER-J®
Smart Home Living

Control ENERJSMART devices with Alexa Instruction

Get your device ready

1. Log in ENERJSMART APP
2. Please ensure you have added supported device in your ENERJSMART account. Please click 'ADD DEVICES' on the home page.
3. Rename the device (Please use standard name such as light, switch, my controller.) Please remember the name for next steps usage.

Connect your Echo to your ENERJSMART System

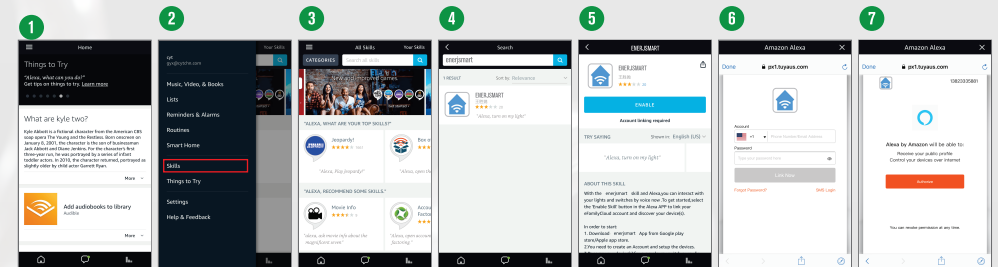

Open Alexa APP, tap on the menu on upper left corner.

Go to 'Skills'

Search for 'ENERJSMART' skill in the search bar

Tap on "ENERJSMART" Skill

Tap "Enable" button

Enter your ENERJSMART account information and tap on "Link Now" to link your ENERJSMART account to your Amazon account

Your Amazon Echo is connected to your ENERJSMART products. Click 'x' on the top right corner to close below page

8

Two ways to discover devices {Device Name}

1. Discover devices on the Alexa APP: 'Home' + 'Smart Home' page, and then click 'Discover Devices'
2. Voice control to discover devices, you could say 'Alexa discover devices'

Control ENERJSMART devices with Alexa Voice control phrase:

Explanation:

- Firstly, you should say 'Alexa' to wake Echo. If it responds, then you will see the blue LED light lighten up around Echo. You may use 'turn on' to open some devices, use 'turn off' to close some devices.
- And at last, you should say the name of the device you want to control.
- Try out these phrases ({Device Name} should be the name of name your device):
- Take light bulb as an example by the name of "light", {Device Name}

1. ON: "Alexa, turn on light {Device Name}. When you hear response 'OK' means control successfully
2. OFF: "Alexa, turn off light {Device Name}
3. Dimming:
 - a. 'Alexa, set light {Device Name} to 80 percent'
 - b. 'Alexa, dim light {Device Name} to 50 percent'
 - c. 'Alexa, dim light {Device Name} by 100 percent'
4. Color changing: 'Alexa set light {Device Name} to blue'

Notes

1. Make sure APP and device firmware update to the latest version.
 2. Supported models: Wi-Fi controller.
 3. Please make sure internet well connected
- For more information, please log on to www.ener-j.co.uk
4. End connectors of led tape are not ip rated and hence need to be enclosed or used inside.