

Smart Tunnel Mirror

40W, Size: 50050060mm, with CCT & Dimming control via APP, Remote Included with UK Adapter, IP44.

SKU : SHA5359

EAN : 5061004712110

Model Number : DTA-20

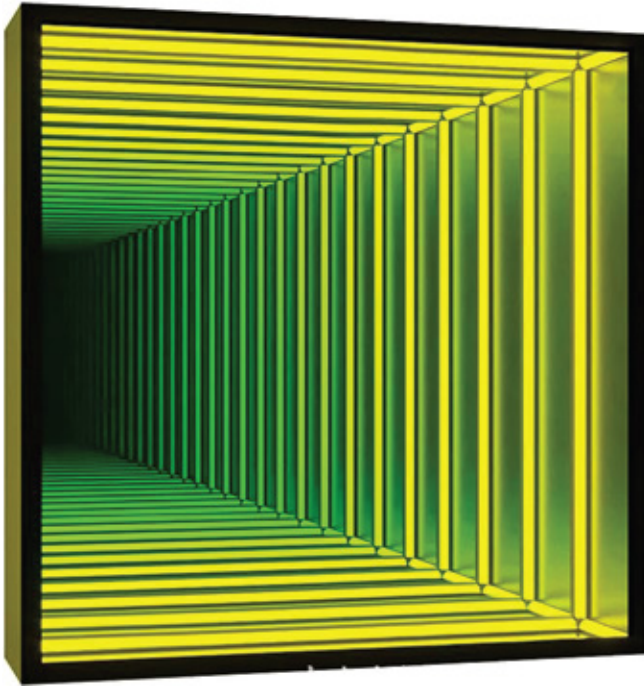

IP44



40W



182 Leds



RGB+CCT



APP
Control



Remote
Control

Feature

- UNIQUE DESIGN** : Adorable 3D mirror tunnel light with fantastic LED illumination. This LED light decoration adds vitality to your bedside table, creating a warm atmosphere in your space. The light can be adjusted to 358 different magical atmospheric effects.
- RGB Color Changing Lights** : Both static and dynamic lighting effects are suitable for any indoor occasion, whether it's adding vibrancy to a romantic dinner or enhancing a casual gathering. Additionally, it's smart enough to remember the last setting even after being shut down.
- Easy to use and install** : The tunnel mirror light comes with a power supply. The hanging hole design at the back of the mirror tunnel light allows you to easily hang it on the wall or on your son's sensory wall. Lighting effects are controlled through a remote control.
- Sensory Infinity Lights** : Our premium sensory lights create the captivating infinity illusion of tunnel lights. It can create a striking illusion. At the same time, when the LED light is off, it is a mirror.
- Wide Application** : This sensory infinity mirror light is suitable for a kid's room, sensory room, bedroom, wedding, holiday, party, birthday, Christmas, New Year or other occasions.

Technical Specification

Model No.	DTA-20
Light Source	LED Strip
Led qty	182leds
Voltage	220V 50Hz
Mirror Rated Power	40W
Material	Stainless steel+tempered glass
Product Size	500*500*60mm
Waterproof level	IP44
Square frame Colour	Black
Colour	RGB+CCT
Installation Method	Mounting
Controll method	Remote control + ENERJ app control
Products with Uk Plug Adaptor	power for plug 12V 3.5A
Packing	1pc/ctn

Package include:

- Mirror*1
- UK Plug Adapter*1
- User Manual*1
- Hanging Board*1
- Touch Remote*1
- Screw bag*1 (include 4 brackets, 4 screws, 4 anchors)

Quick Setup

Contents

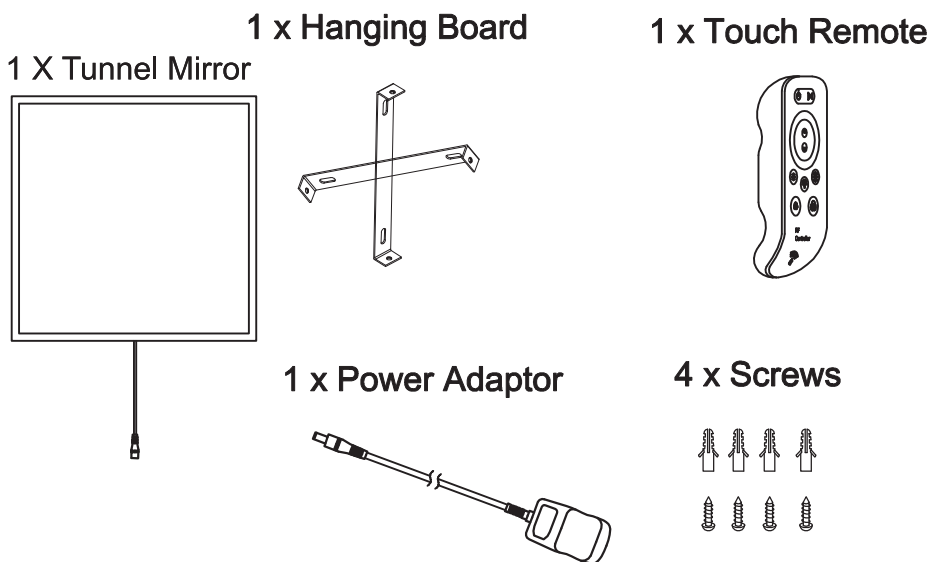

Complete Setup

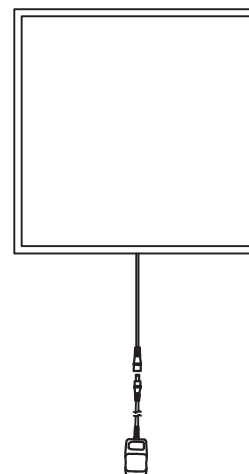

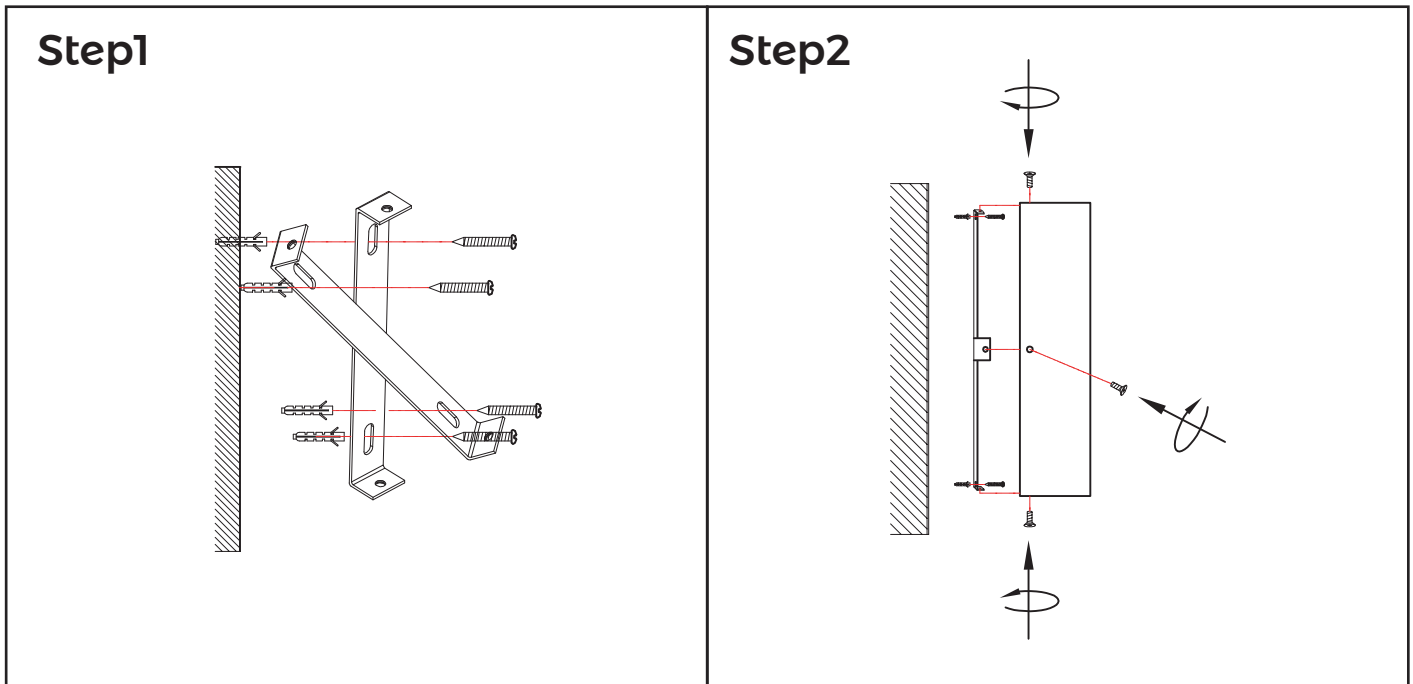

Step 1: Attach the mounting frame securely to the wall.

Step 2: Follow the provided diagram to connect the power cord and securely fasten the lamp to the mounting frame using the screw.

Thank you & enjoy your new amazing light show !!!

Caution:

1. Do not exceed the specified power supply range (100-240V AC, 50/60Hz). Take care to avoid scratching the surface during lamp installation.
2. This product is not intended for outdoor use. Use only a soft cloth or tissue to clean. Keep chemicals or liquids away from the lamp.

Advanced instructions

Remote instructions

1. **Timer setup:** Quickly press the timer button until the white light flashes. Flash 1x to set up the timer for 1 hour to automatically turn off the lamp, flash 2x, 3x, 4x, or 5x to set up the timer for 2 hours, 3 hours, 4 hours, or 5 hours respectively. *Turn off the lamp to cancel the timer setting.
2. **M+/-:** Mode plus, mode minus
3. **Music mode:** To select the next music mode, press the music button.
*To exit music mode, simply press the color ring or normal mode button.
4. **Speed +/-:** Use the speed plus (+) button to increase speed and the speed minus (-) button to decrease speed in running modes.
5. **Music sensitivity +/-:** Adjust music mode sensitivity using the sensitivity plus (+) and minus (-) buttons.
6. To pair 1 or 2+ lamps to a single remote, press and hold the On/Off button for more than 5 seconds until the light flashes three times.
7. To unpair the lamps, press and hold the On/Off button for more than 5 seconds until the light flashes three times.

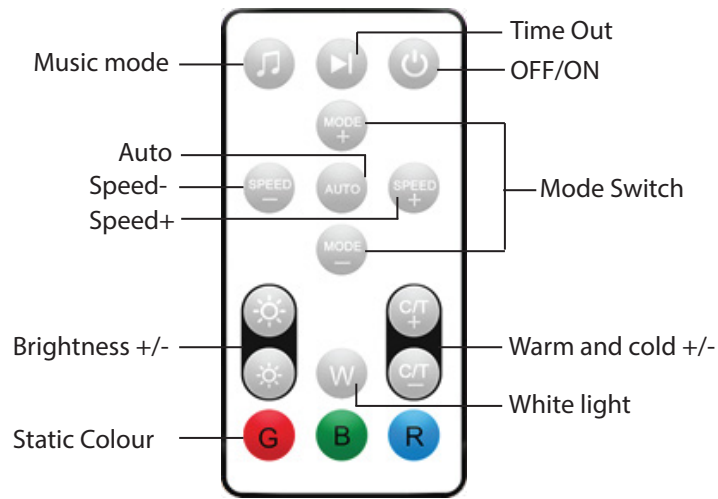

1. How to Pair/Unpair the Remote with the Product:

To pair or unpair the remote control with the product, press and hold the "On/Off Key" on the remote.

2. Note about Remote Batteries:

Please be aware that remote batteries are not included. The remote requires 3 x AAA batteries.

Make sure to insert the specified batteries to operate the remote control effectively.

APP instructions



Step 1: Scan the QR Code or search for 'ENERJSMART' or 'Tuya Smart' on the App Store or Google Play to download and install the app for iOS/Android. Make sure your mobile phone's system version is Android 5.0 or above or iOS 9.0 or above.

Step 2: Launch the 'ENERJSMART' or 'Tuya Smart' app on your phone. Tap on 'Sign Up' to create an account using your email address (if you already have an account, please log in). Verify your account using the verification code sent to your email.

Step 3: Log into your account and follow the app's instructions to create a 'Family.' Then, refer to the instructions below to add devices to your 'Family.'

Follow below steps to connect the lamp to the app,

Step 1: Enable Bluetooth, Location, and Wi-Fi or Personal Hotspot.

Step 2: Open the Tuya Smart App and select one of the following three options to add the smart lamp to the app.

Option 1: Find the related device to be added. Go to "Add," choose Wi-Fi, enter the password, click "Next," and wait for successful addition.

Option 2: Click "+" on the top right corner of the home page, then select "Auto Scan." Search for nearby devices, choose Wi-Fi, enter the password, click "Next," and wait for successful addition.

Option 3: Click the '+' icon at the upper right corner of the home page, then choose 'Add Manually,' followed by 'Lighting' and 'Light Source.' Search for nearby devices, select Wi-Fi, enter the password, click 'Next,' and wait for the successful addition.

Follow the steps below if you fail to connect the lamp to the Tuya Smart App using the previously mentioned options:

1. Follow the above steps to connect again
2. If you cannot, remove the added device, and then follow the above steps to connect again.
3. If failed again, click the music key "🎵" five times to clear the added device, and then follow the above steps to connect.
4. If you still cannot connect, switch off the power plug three times to reset the added device, and then follow the above steps to connect again.

Notice

1. The Tuya Smart Wi-Fi is compatible with 2.4G internet and cannot be used with 5G internet.
2. Maintain a strong signal between the lamp and the Wi-Fi router.

How to connect lamp to Amazon Alexa / Google Assistant You can learn the detailed instruction on "Me" "More" of Thirdparty Voice Services" page of the APP. Tap the corresponding service to learn more and how to set up

How to Reset the Product:

Press and hold the "Music Button" on the remote control until the light flashes, which will unbind the device from the app and restore it to factory settings.

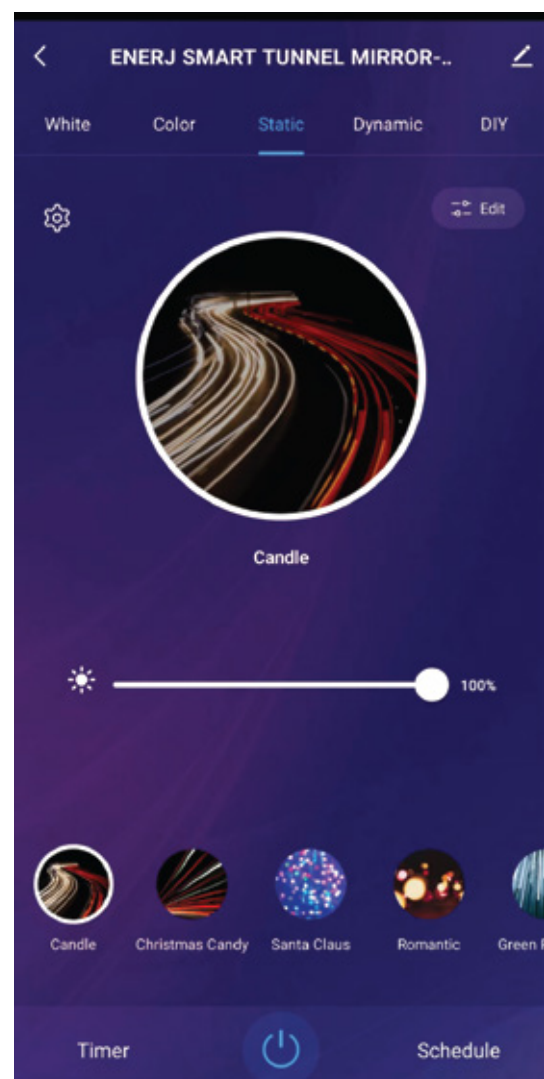
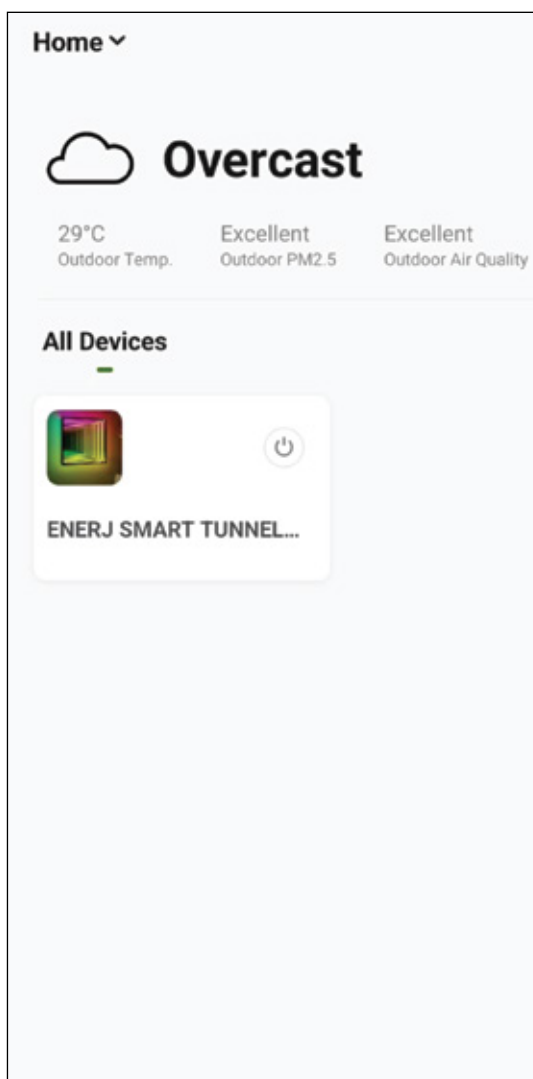

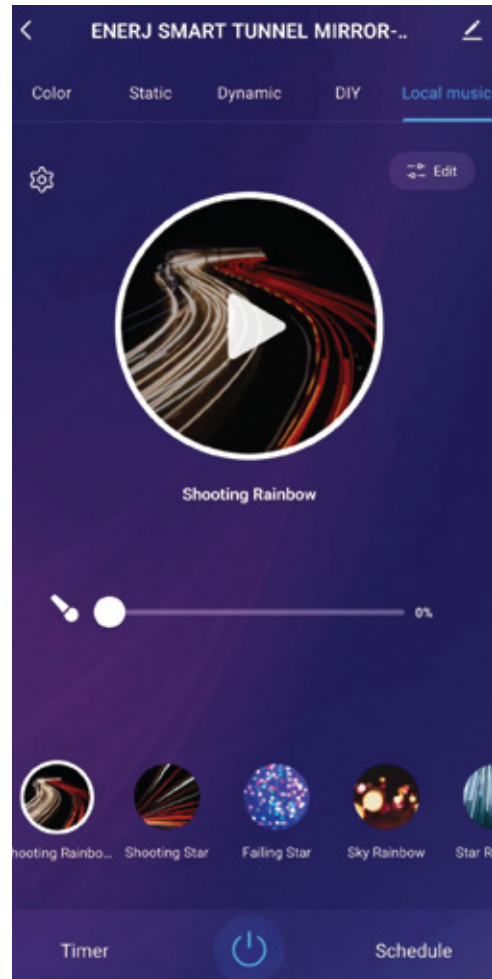
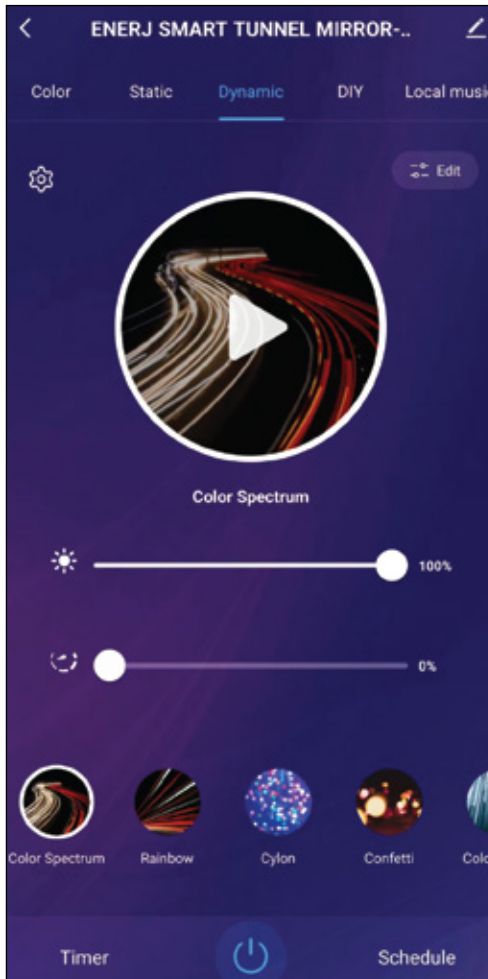
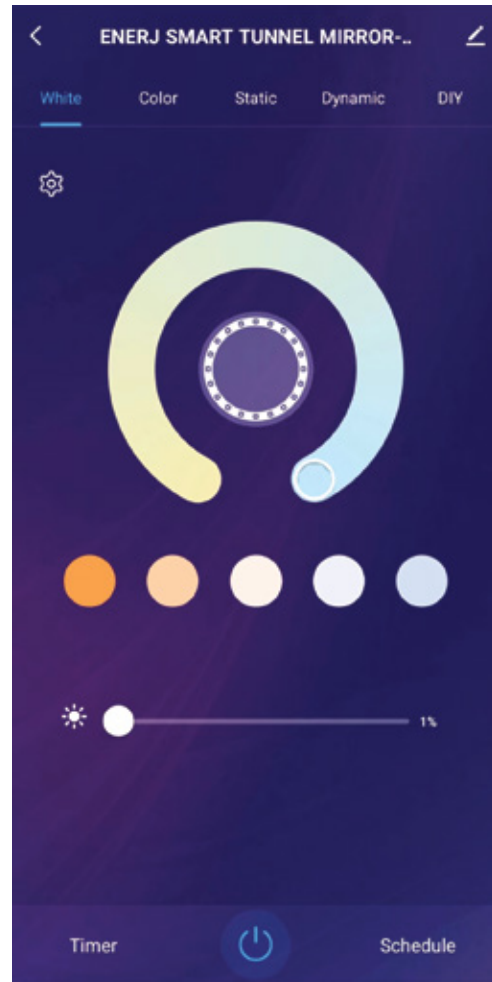
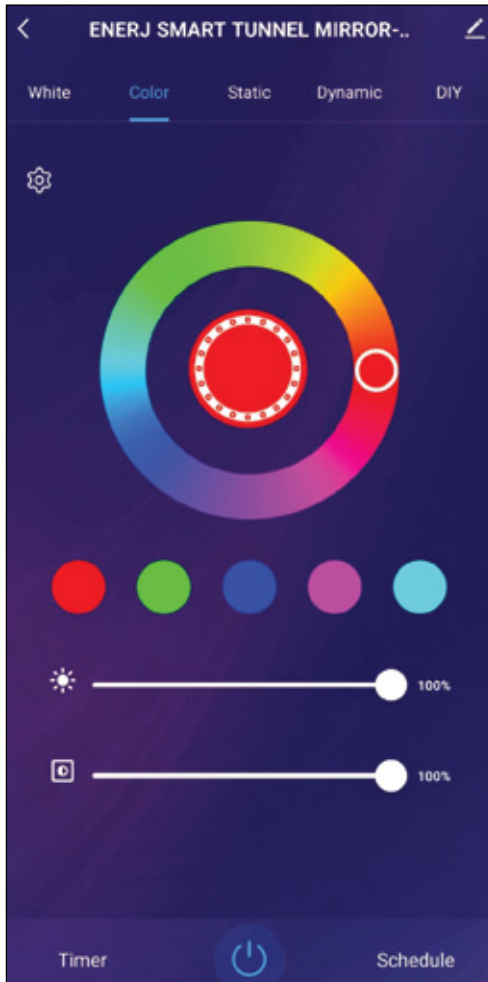

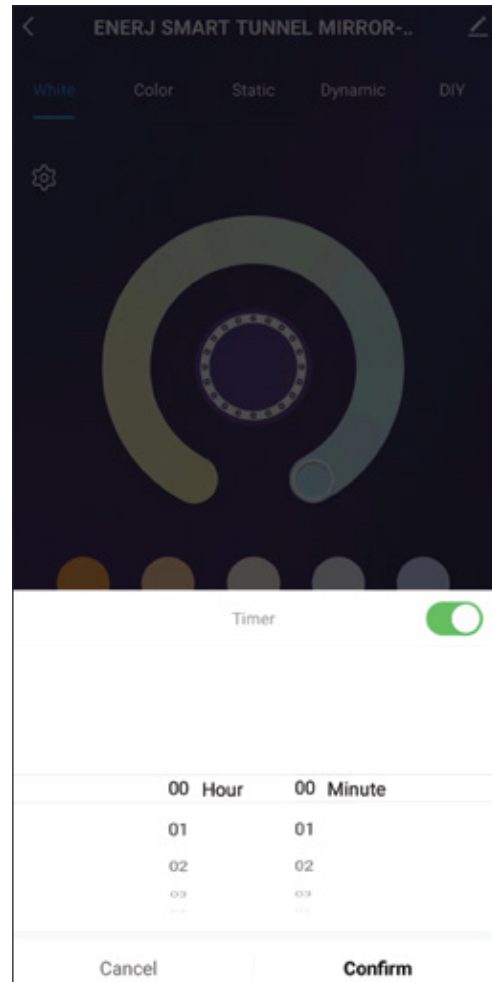
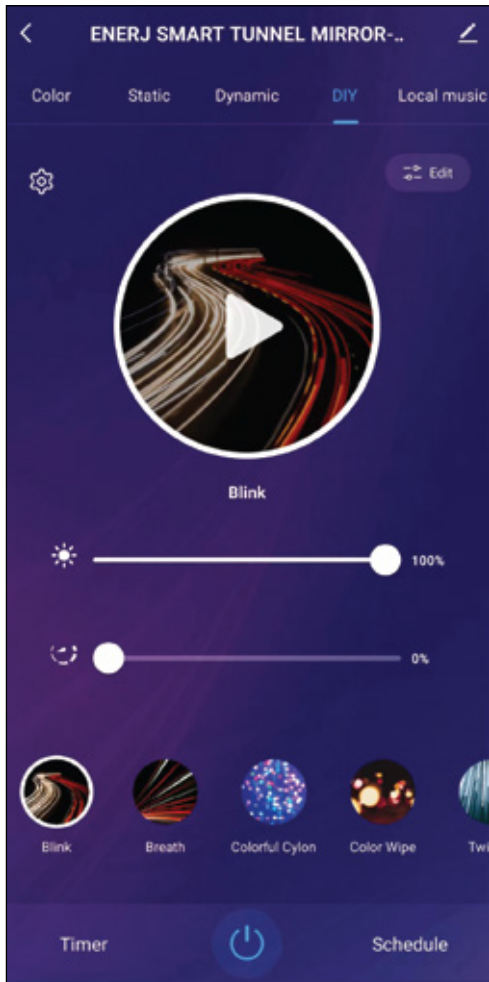

Stuck? Confused?

Contact our Technical Support team on:
 T: +44 (0)1291 446 105 E: support@ener-j.co.uk
 Lines are open Mon - Fri (8am to 4pm)

Imported and Marketed By:
 ENERJ SMART LTD.
 Unit 11D cosgrove Way, Luton LU11XL,
 United Kingdom