

DOOR SENSOR INSTRUCTION

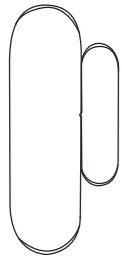

Product configuration

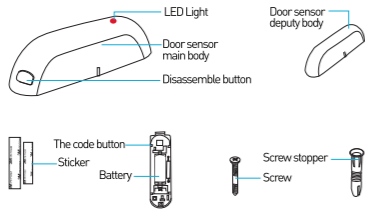

Reset:

- (1) Press the reset button for 6 seconds till the indicator flash rapidly. Then device turns to smart wifi mode.
- (2) Press the reset button again for 6 seconds till the indicator flash slowly. The device turns to AP mode.

Specifications

Battery: CR2-3V x 1
Standby current: 13uA
Working current: 115mA-120mA
Standby time: 5 years
Working time: 1 year (15 times/day); 2 years (7 times/day)
Wireless type: 2.4GHz
Wireless standard: IEEE 802.11b/g/n
Wireless range: 45M
Operating Temperature: 0°C ~ 40°C (32°F ~ 104°F)
Operating Humidity: 20% ~ 85%
Storage Temperature: 0°C ~ 60°C (32°F ~ 140°F)
Storage Humidity: 0% ~ 90%
Size: Main body: 71mm x 21mm x 22mm
Small body: 40mm x 11mm x 11mm

Download App

1. Android phone: Download "ENERJSMART" from Google play store
2. IOS device: Download "ENERJSMART" from APP store.

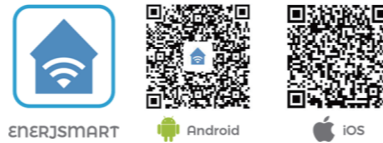

Register and login

1. Run "ENERJSMART" from your smartphone.
2. Register and login

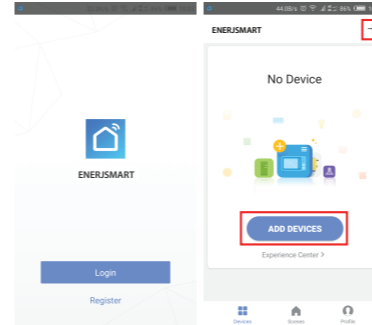

Add Device

Select the item that you want to add, add the device via Smart Wifi or AP mode

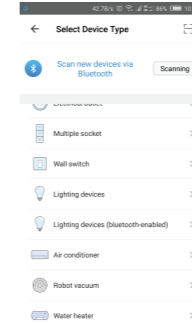

Network Configuration

1. Smart WiFi Mode:

Pressing the resetting button for 6s, the LED will rapidly blink. That is Smart Wifi mode.

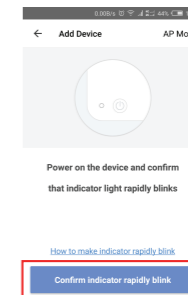

2. AP mode:

Pressing the resetting button for 6s after the LED blink slowly, the device is in AP mode to configure the network.

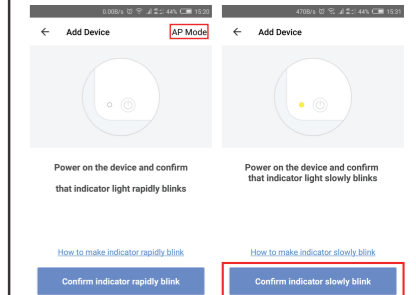

Main function

1. Working status, open/close the door
It takes 3-5 seconds to receive the notification pushing when it is triggered.

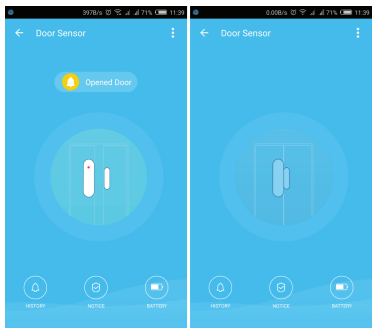

2. Alarm recording (click "HISTORY")
3. Turn on and turn off the alarm (click "NOTICE"). No alarm pushing will be received after alarm closed, only alarm record can be received.)

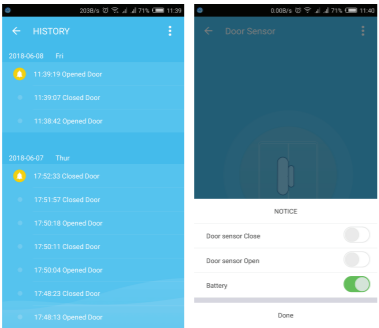

Alarm recording

Turn on/off the alarm

4. Linkage setting, by setting the Scenes to link two devices (door sensor used for active conditions only)

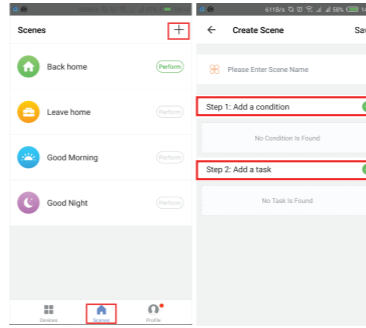

Device Sharing

Allow others to control the device by sharing device (note: you can delete the sharing in profile setting)

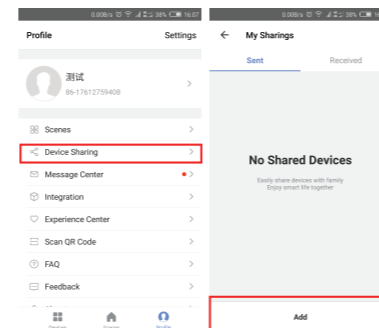

Push Notification

Enable to turn off.

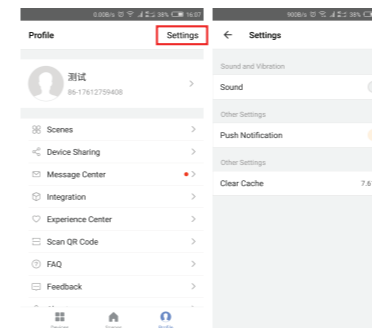

Remove device

The device will restore default settings.

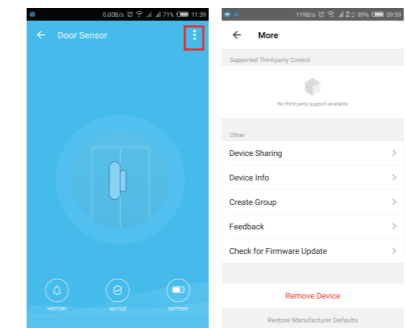

LED State

Device Status	LED State
Smart Wi-Fi	Indicator flashes quickly
AP mode	Indicator flashes slowly
Turn on	Indicator flashes
Turn off	Indicator off
Reset	Indicator lights up for 4s and after 2 seconds lights off, device goes into configuration mode



Make Your Home Smarter