

ENER-J Smart WiFi Dimmable Light Switch Module

Seamless Brightness Control with App & Voice,
Alexa & Google Assistant Compatible

ENER-J®
Smart Home Living

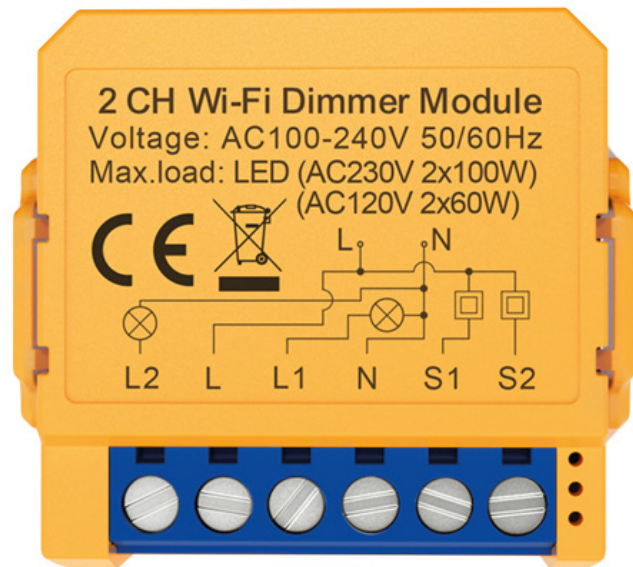
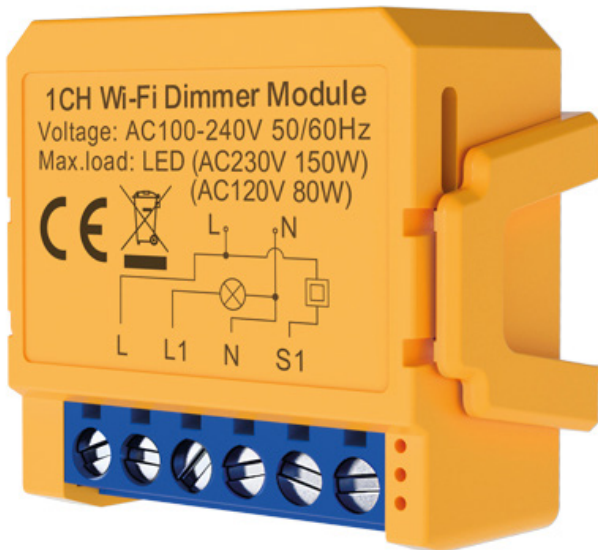

SKU Code: SHA8008
SHA8009

Product Description:

Transform your lighting experience with the ENER-J Smart WiFi Dimmable Switch Module. Designed to fit seamlessly into your existing setup, this ultra-compact dimmer module offers precise brightness control from 0% to 100%, customizable for any mood or occasion. With app-based and voice control capabilities, it's perfect for creating the ideal ambiance at your fingertips. Easy to install and packed with advanced features, this smart dimmer redefines modern living.

Key Features:

- ▶ **Ultra-Mini Design:** A compact 39x39x19.4 mm body, fitting into 98% of standard switch boxes.
- ▶ **Stepless Dimming:** Smoothly adjust brightness levels from 0% to 100% for various scenes like movie night, reading, or parties.
- ▶ **App & Voice Control:** Effortless control via the Smart Life/Tuya app or voice assistants like Alexa and Google Assistant.
- ▶ **Dual-Way Control:** Upgrade two-way switches without rewiring your home.
- ▶ **Memory Function:** Automatically restores the previous brightness level after a power outage or lets you preset a specific level.
- ▶ **Customizable Schedules:** Set timers, countdowns, or schedules to automate your lighting needs.

Technical Specification:

Product Type	1 Gang / 2 Gang WiFi Dimmer AC
Voltage	100-240V, 50/60Hz
Max Load	LED 250W, 10A
Operation Frequency	2.412GHz-2.484GHz
Operating Temperature	-10°C to +40°C
Protocol	WiFi IEEE 802.11b/g/n
Operation Range	<100m
Dimensions	39x39x19.4 mm
IP Rating	IP20



What's in the Box?

- 1 x ENER-J Smart WiFi Dimmable Switch Module
- Installation Guide
- Mounting Accessories



Mini

Mini
body



Easy
installation



Voice
control



Family
share



App
control



Timing
function



2 Way
control



Product Size

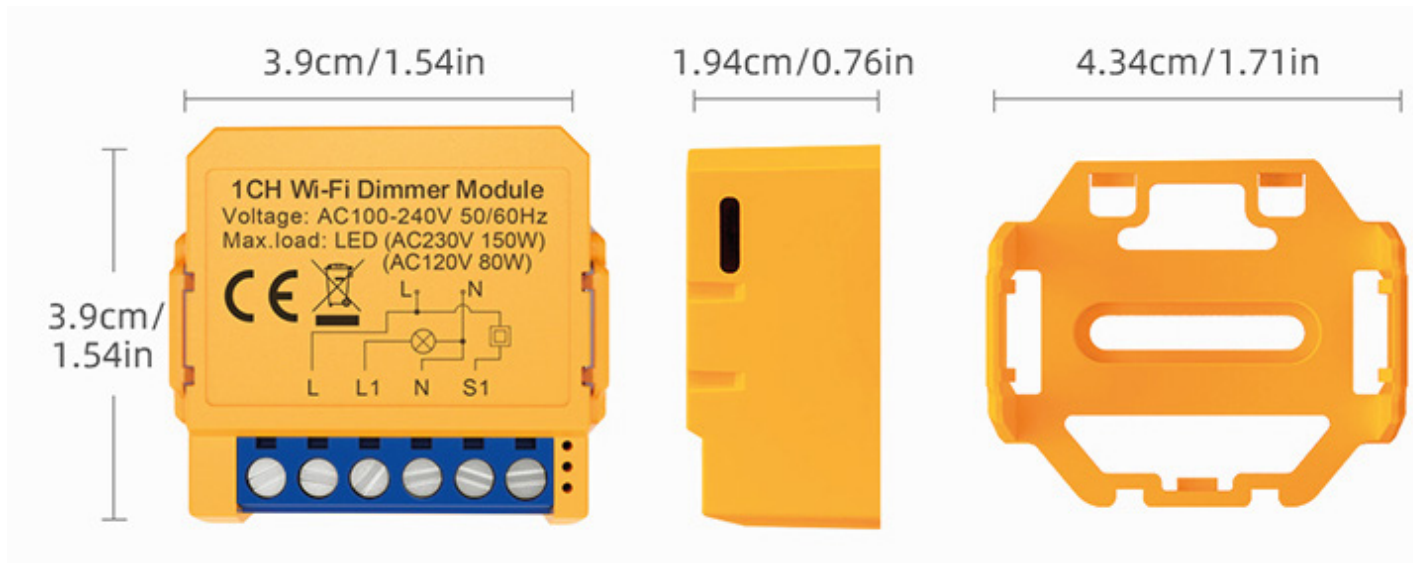

Wiring Diagram

2 gang 1 Way Control

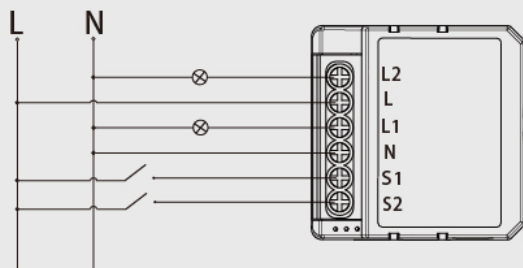

2 gang 2 Way Control

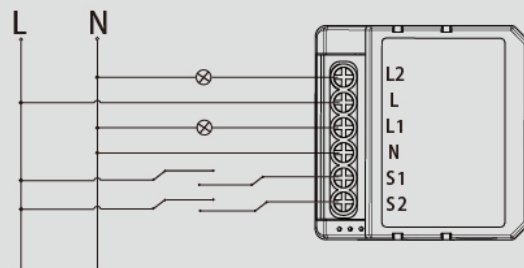

1 gang 1 Way Control

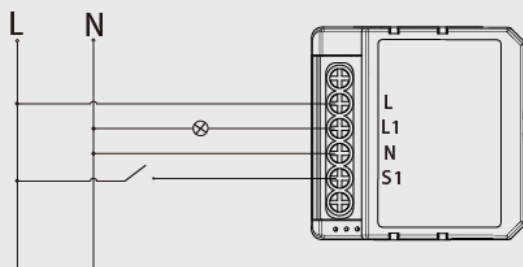

1 gang 2 Way Control

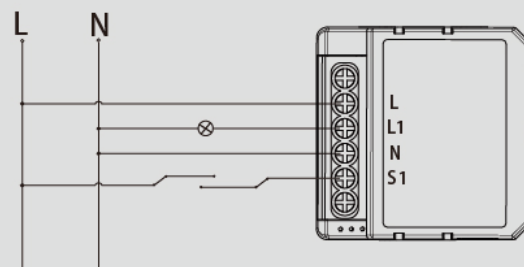

Pairing Instruction



IOS APP / Android APP

1

Scan the QR code to download Tuya Smart App, or you can also search keyword "Tuya Smart" and "Smart Life" at App Store or Googleplay to download App.



2

Log in or register your account with your mobile number or e-mail address. Type in the verification code sent to your mobile or mail box, then set your login password. Click "Create Family" to enter into the APP.

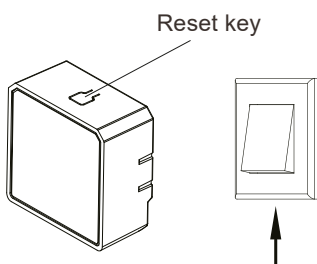

3

After the wiring of switch module is done, press the reset key for about 10 seconds or Press traditional dimmer off (the one connected to the wi-fi dimmer module). Then press and hold for 10 seconds until light connected to the module will quickly and enter into configuration mode or until the indicator light inside the module is flashing quickly for pairing.

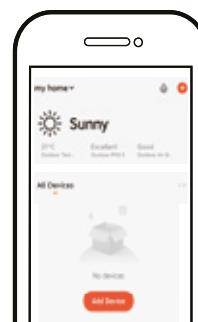

4

1. Support multi-protocol matching: WIFI/Bluetooth.
2. Turn on Bluetooth, Click "+", follow the on-screen instruction for pairing.



5

The connecting will take about 10-120 seconds to complete depending on your network condition.

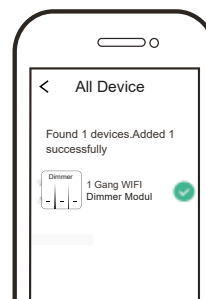

6

Finally, you can control the device via your mobile phone.

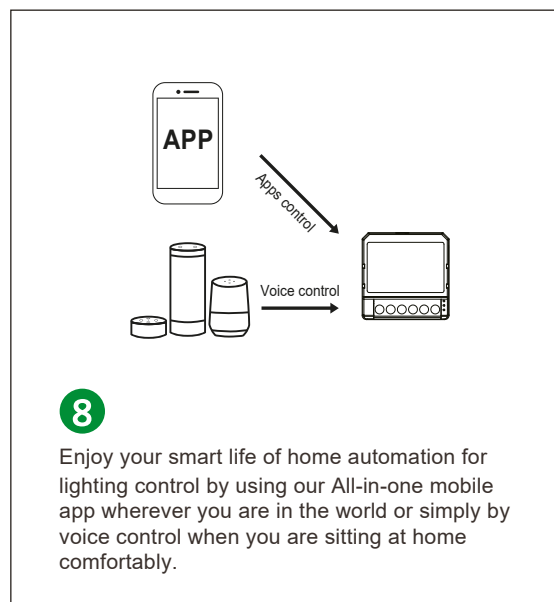
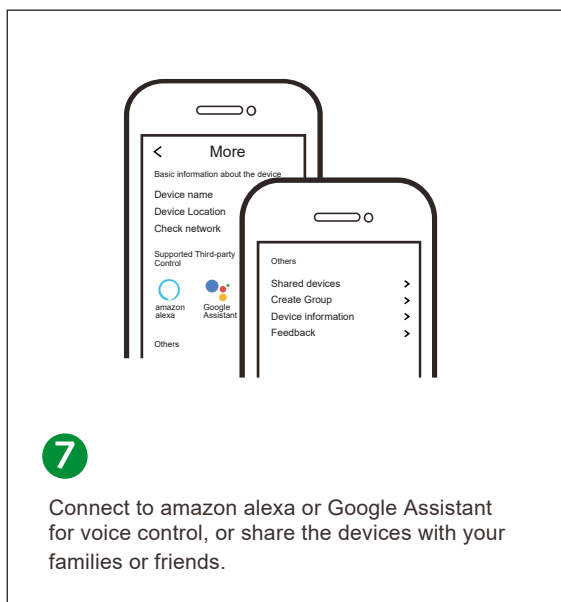

FAQ

Q1: What should I do if I can't configure the switch module?

- Please check whether device is powered on.
- Make sure your mobile and dimmer module are the same 2.4 Ghz WIFI network.
- Whether it's in good internet conditions.
- Make sure the password entered in App is correct.
- Make sure the wiring is correct.

Q2: What device can be connected to this Wi-Fi switch module?

Support triac dimming LED or tungsten lamp

Q3: What happens if the WIFI goes off?

You can still control the light connected the dimmer module with your traditional switch and once WIFI is active again the device connected to module will connect automatically to your WIFI network.

Q4: What should I do if I change the WIFI network or change the password?

You have to re-connect our Wi-Fi dimmer module to the new Wi-Fi network accordingly as per the App User Manual.

Q5: How do I reset the device?

Press traditional dimmer off (the one connected to the wi-fi dimmer module). Then press and hold for 10 seconds or more until lamp connected to the module will flick quickly and enter into configuration mode.

Group-Control Function



Timing/Count Down/Schedule

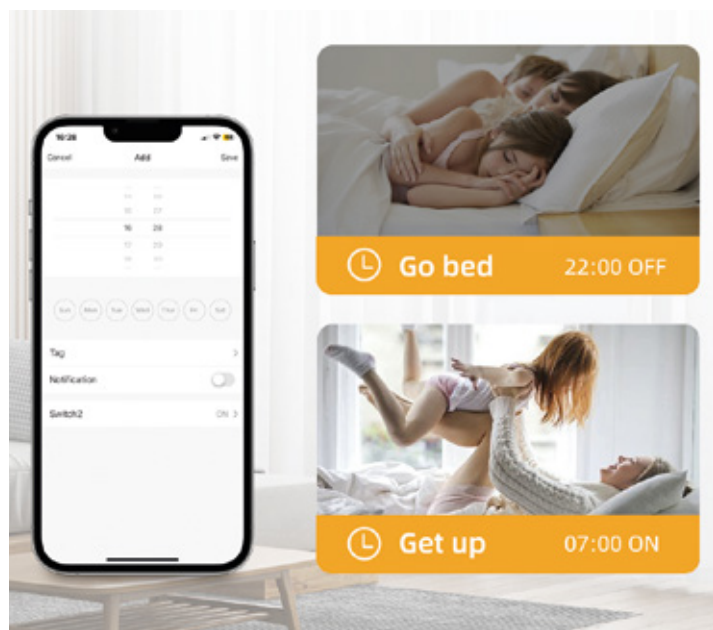

Thank you for choosing ENER-J!

Customer satisfaction is our TOP priority, please let us know how you felt about your experience. Happy? We are so happy that you are pleased with our product. Feel free to express your newfound joy! Share your experience by writing a review.

Not Happy? If you are not fully satisfied with the item you received, have any problems like damages, or questions, please contact us. We typically respond within 24-48 hours.

Have a question? We're happy to help!

Contact us on:

T: +44 (0)1291 446 105 E: support@ener-j.co.uk

Lines are open Mon - Fri (8am to 4pm)