



ENER-J®

Smart Home Living

TriGlow Flex

LED Floodlight

Switch between 6000K, 4000K
& 3000K - Sensor Ready!



30W, 50W &
100W



90lm/W



IP 65



SMD
LED

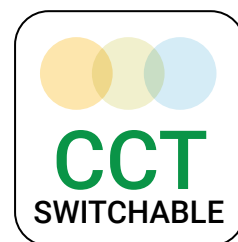

SKU CODE:

T205X	30W
T207X	50W
T210XN	100W

Packing

Inner packing Qty
1 pc/ Box

Outer Carton Packing Qty
1 sets/Carton

Description

Illuminate your space with our versatile LED Floodlight, featuring CCT switchable technology (6000K to 4000K to 3000K) and the option to add sensors for enhanced functionality. Designed for both indoor and outdoor use, this robust floodlight offers excellent energy efficiency and durability, making it an ideal choice for various applications.

Features

- **CCT Switchable:** Easily switch between different color temperatures to customize your lighting environment according to your needs and preferences.
- **High Efficiency:** With a luminous efficacy of 90lm/W, this floodlight provides bright illumination while conserving energy.
- **Durable Construction:** Made from die-cast aluminum with a transparent glass diffuser, this floodlight is built to withstand harsh conditions, ensuring long-lasting performance.
- **Wide Beam Angle:** Featuring a 110° beam angle, this floodlight covers a wide area, making it suitable for both residential and commercial settings.
- **Attachable PIR Sensors:** Designed to be compatible with attachable sensors (not included), allowing for customized functionality such as motion detection.

Technical Parameters

	30W	50W	100W
Model	DFL204-30W	DFL204-50W	DFL204-100W
SKU	T205X	T207X	T210Xn
Luminous flux of luminaire (lm)	2700 lm	4500 lm	9000 lm
Net Weight	0.38KG	0.54KG	1.08KG
Dimensions (L x W x H mm)	140x120x28	175x140x28	260x215x30
Luminous Flux of Full LEDs	3350	5700	11500
Quantity of LED diodes/chips	72 PCS	112 PCS	224 PCS
Power cable	0.5m H05RN-F3G 1.0mm ² cable	0.5m H05RN-F3G 1.0mm ² cable	1m H05RN-F3G 1.0mm ² cable
Supply Voltage (V)	220-240V AC		
Frequency (Hz)	50/60Hz		
Power Factor (cos φ)	>0.9		
IP Rating (without PIR Sensor)	IP65		
IP Rating (with PIR Sensor)	IP44		
Protection Class	Class I		
IK Rating	IK07		
Beam Angle	110°		
Operating Temperature	-25°C to 40°C		

Tc Temperature	100°C
Luminous Efficacy of Luminaire	90lm/W ±10%
Efficiency of Luminaire	80%
Driver	Linear Driver
Microwave Motion Sensor	No
Base Material	Die-cast Aluminum
Base Colour	Black
Diffuser Material	Glass
Diffuser Type	Transparent
Mounting Bracket Material	Iron
Mounting Bracket Colour	Black
Luminous Efficacy of LEDs	110-120 lm/W
CCT (K)	3CCT
LED Type	SMD2835
CRI	>80
Number of Switching Cycles	>10,000
LED Lifespan (Hours)	30,000
Warranty (Years)	3 Years
CE Certified	Yes
RoHS Declaration	Yes



Attachable PIR Sensors for T205X, T207X and T210XN CCT Floodlight



SKU: ACC1092



Description

Enhance the functionality of your LED floodlights with our attachable infrared motion sensor. Designed for the T205X, T207X, and T210X models, this sensor provides energy-efficient, automatic lighting control. It uses advanced infrared technology to detect motion and adjust lighting based on occupancy.

Features

- **Energy-Saving Automation:** Automatically controls lighting by detecting motion, ensuring lights are only on when needed, saving energy and costs.
- **Infrared Transmitting Device:** Unique design for reliable and precise control (see image for details).
- **Adjustable Sensitivity:** Easily customize sensitivity to suit different environments and conditions. Adjust according to installation height and ambient temperature for optimal performance.
- **Dual Working Modes:** Switch between day and night modes. Day mode offers all-weather sensing, while night mode activates in low-light conditions, providing flexibility for various applications.

- **Customizable Induction Time:** Set the sensor's output duration to match your requirements, from a minimum to a maximum output time, ensuring tailored performance.
- **Wide Detection Range:** Covers a 120° induction angle with a distance of 4-10 meters, perfect for both residential and commercial spaces.

Technical Parameters

SKU	ACC1092
Operating Voltage	DC 5V
Maximum Load	50W
Delay Time	5S ± 3S - 8m ± 1m (adjustable)
Induction Angle	120°
Induction Distance	4-10 meters (adjustable)
Waterproof Grade	IP44
Ambient Illumination	5-2000 Lux (adjustable)
Moving Speed	0.6-1.5 m/s
Installation Height	2.5-3 meters
Operating Temperature	-20°C to +40°C

Product Size

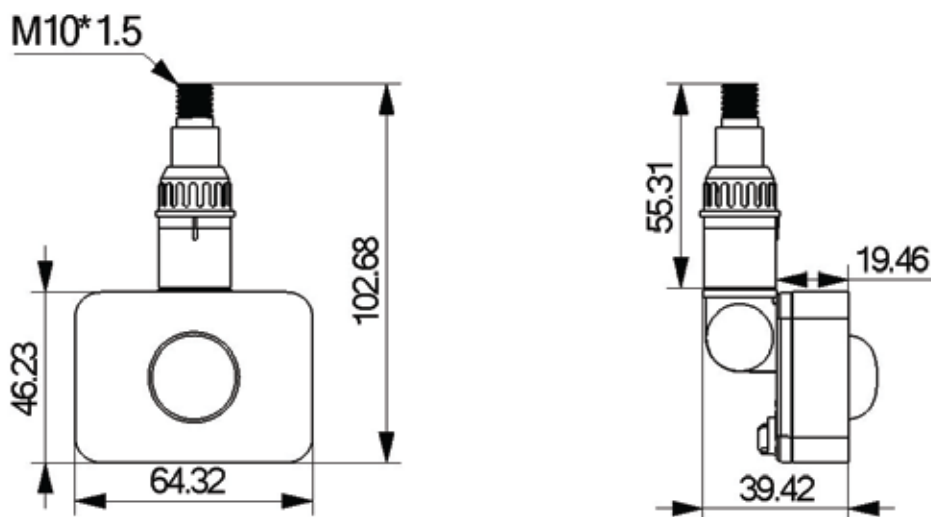

Installation and wiring diagram

The red line connects to the 5V positive pole and the black line ground the negative pole, and the white line connects to the output to provide PWM signal (5V-- Red line (positive) GND-- Black line (negative) out-white line (output))

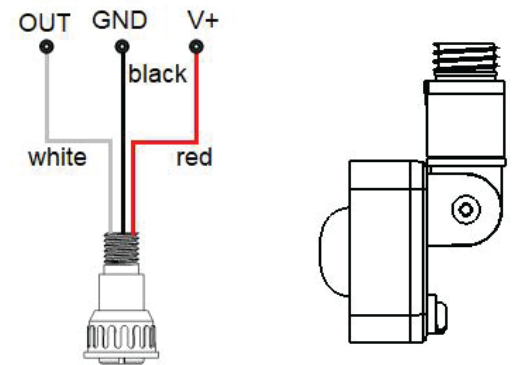

Induction range diagram

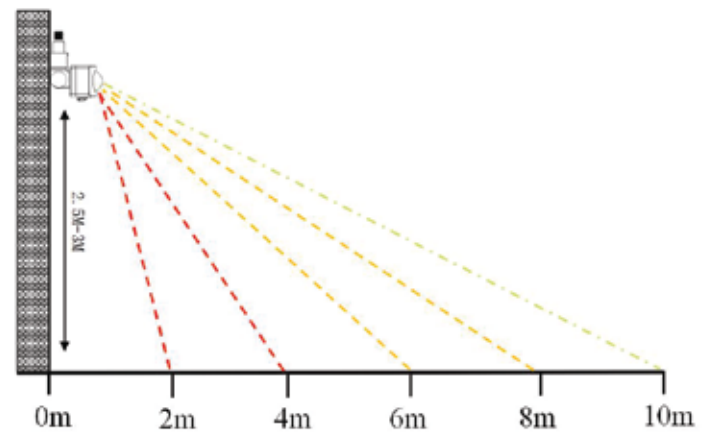
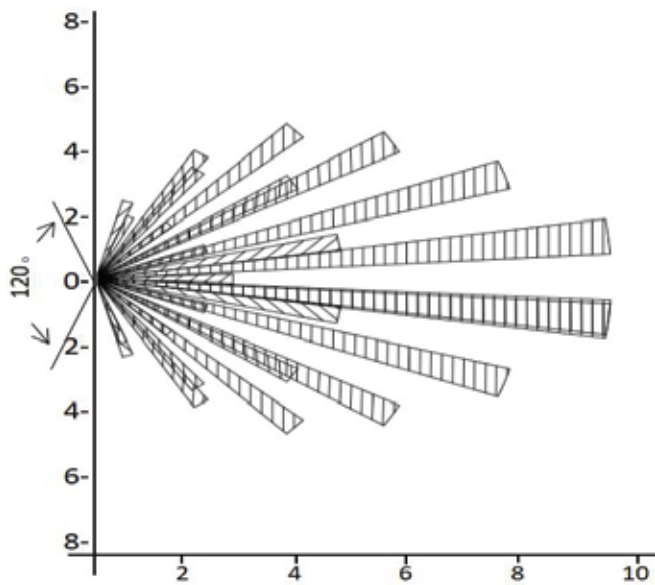

Stuck? Confused?

Contact our Technical Support team on:

T: +44 (0)1291 446 105 E: support@ener-j.co.uk

Lines are open Mon - Fri (8am to 4pm)